

SC21G

Universal Compressor

R134a

220-240V 50Hz

Data Sheet (Replaces CD.44.L7.02)

General

Compressor	SC21G
Code number	104G8140
Code number	104G8124
Code number (UL-recognized)	104G8143

Application

Application		LBP/HBP
Evaporating temperature range	°C	-35 to 15
Voltage range*)	V/Hz	LBP: 187 - 254 /50
		LBP: 198 - 254 /60
		HBP: 198 - 254 /50
Motor type		CSR
Max. ambient temperature	°C	43
Comp. cooling at ambient temp.	32°C	LBP: F ₂ HBP: F ₂
	38°C	LBP: F ₂ HBP: F ₂
	43°C	LBP: F ₂
		HBP: F ₂

*) Not applicable below -25°C evaporating temperature in 43°C ambient temperature above 240V.

Design

Displacement	cm ³	20.95
Oil quantity	cm ³	550
Maximum refrigerant charge	g	1300
Free gas vol. in compressor	cm ³	1460
Weight without electrical equipment	kg	13.5

Motor

Motor size	watt	550
LRA (rated after 4 sec. UL984) HST	A	21.8
Cut-in current HST	A	21.8
Resistance, main and start winding (25°C)	Ω	3.5/12.1
Approvals (104G8140/24)		EN 60335-2-34
Approvals (104G8143)		UL984/CSA-C22.2

Dimensions

		104G8140/43	104G8124
Height	mm	A	219
		B	213
		B1	193
		B2	110
Suction connector	location/I.D. mm	C 10.2 ±0.09	10.2 ±0.09
Process connector	location/I.D. mm	D 6.2 ±0.09	6.5 ±0.09
Discharge connector	location/I.D. mm	E 6.2 ±0.09	6.5 ±0.09
Compressors on a pallet	pcs.	80	

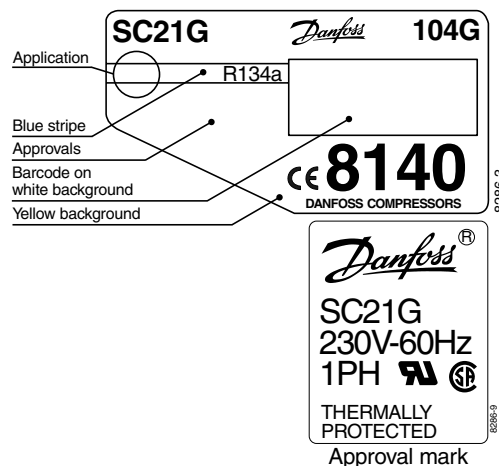

- S = Static cooling normally sufficient
- O = Oil cooling
- F₁ = Fan cooling 1.5 m/s (compressor compartment temperature equal to ambient temperature)
- F₂ = Fan cooling 3.0 m/s necessary

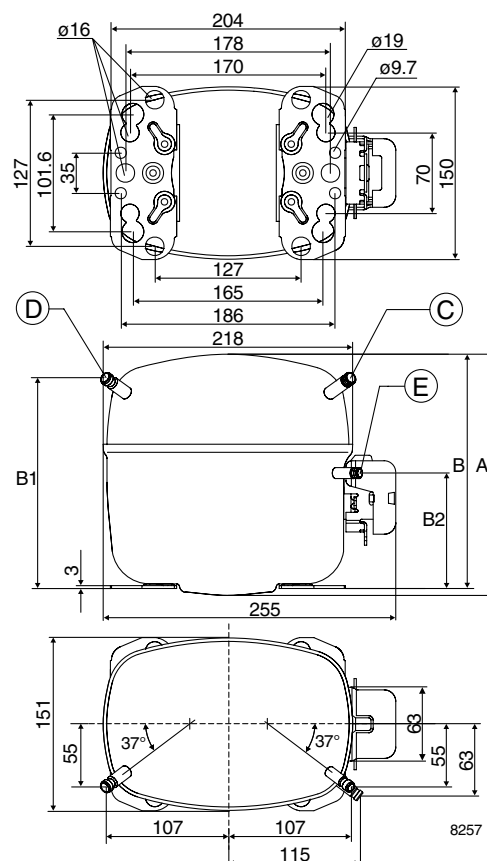

Drawing shows standard SC housing cover. On housing cover of type 104G8124 suction and process connectors are interchanged.

Capacity (EN 12900/CECOMAF)

watt

Comp.\°C	-25	-23.3	-20	-15	-10	-5	0	5	7.2	10	15
SC21G	333	370	453	606	792	1012	1268	1560	1700	1889	2256

Capacity (ASHRAE)

watt

Comp.\°C	-25	-23.3	-20	-15	-10	-5	0	5	7.2	10	15
SC21G	410	456	558	746	977	1250	1568	1931	2106	2343	2803

Power consumption

watt

Comp.\°C	-25	-23.3	-20	-15	-10	-5	0	5	7.2	10	15
SC21G	382	404	445	509	575	643	714	789	823	868	953

Current consumption

A

Comp.\°C	-25	-23.3	-20	-15	-10	-5	0	5	7.2	10	15
SC21G	2.28	2.34	2.48	2.71	2.96	3.24	3.54	3.87	4.02	4.22	4.60

COP (EN 12900/CECOMAF)

W/W

Comp.\°C	-25	-23.3	-20	-15	-10	-5	0	5	7.2	10	15
SC21G	0.87	0.92	1.02	1.19	1.38	1.58	1.78	1.98	2.07	2.18	2.37

COP (ASHRAE)

W/W

Comp.\°C	-25	-23.3	-20	-15	-10	-5	0	5	7.2	10	15
SC21G	1.07	1.13	1.25	1.47	1.70	1.95	2.20	2.45	2.56	2.70	2.94

Test conditions

EN 12900/CECOMAF

ASHRAE

Condensing temperature

55°C

55°C

Ambient and suction gas temp.

32°C

32°C

Liquid temperature

55°C

32°C

Fan cooling, 220V 50Hz

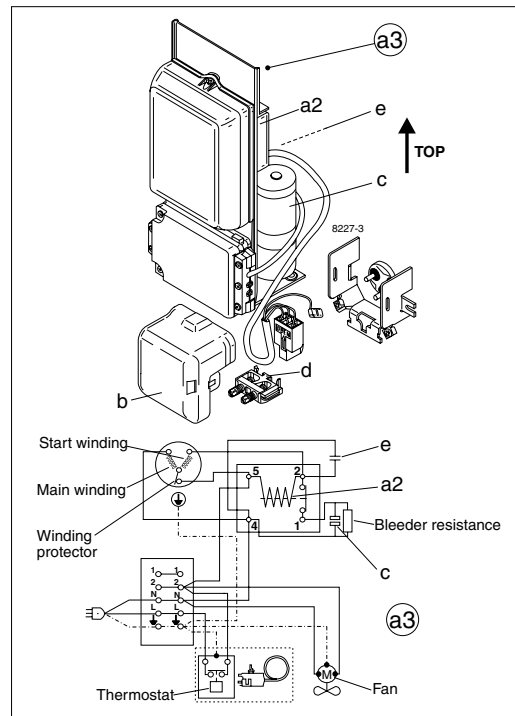

Accessories

Devices	Fig.	SC21G
Starting device (104G8140/24)	a3	117-7028 (470 mm cable length) 117-7029 (550 mm cable length) 117-7032 (650 mm cable length)
Starting device (104G8143)	a3	117-7038 (470 mm cable length) 117-7039 (550 mm cable length) 117-7043 (1000 mm cable length)
Cover (104G8140/24)	b	103N2009
Cover (104G8143)	b	103N2008
Starting relay	a2	Components of starting device
Starting capacitor	c	
Run capacitor	e	
Cord relief	d	103N1004
Mounting accessories		
Bolt joint for one compressor		118-1917
Bolt joint in quantities		118-1918
Snap-on in quantities		118-1919

Danfoss can accept no responsibility for possible errors in catalogues, brochures and other printed material. Danfoss reserves the right to alter its products without notice. This also applies to products already on order provided that such alterations can be made without subsequential changes being necessary in specifications already agreed. All trademarks in this material are property of the respective companies. Danfoss and the Danfoss logotype are trademarks of Danfoss A/S. All rights reserved.